

CRANKSHAFTS



FORGED RACING CRANKSHAFTS

FORGED 5140 SERIES

Our NEW Forged 5140 chrome moly steel crankshafts are an excellent upgrade from factory cast or forged crankshafts without the big price tag. These cranks have many of the same features found in more expensive cranks, such as lightening holes, multi-stage heat treat process and computer designed counterweights to reduce main bearing load. These cranks are perfect for high performance street, pro-street, bracket racing and offer an excellent value for budget conscious performance engine builders.

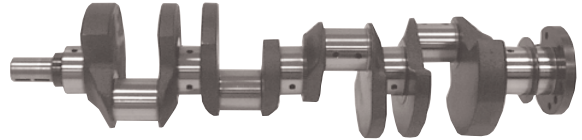

Note: Require M77 "H" bearings or Federal Mogul performance bearings for large crank radius.

These cranks can be ordered with any P.A.W. engine kit. Phone for upgrade prices.

5140 Steel Cranks				Stroke	Rod Length	Price	5140 Steel Cranks				Stroke	Rod Length	Price
CHEVROLET							CHEVROLET Continued						
350 Chevy	CRK51403505700	3.480"	5.700"			\$399.00	350/383 SB Chevy	CRK51403836000*	3.750"	6.000"			\$409.95
350/383 SB Chevy	CRK51403835700*	3.750"	5.700"			\$409.95	400 SB Chevy	CRK51404005700*	3.750"	5.700"			\$399.00
350/383 SB 1-PC	CRK5140383571P*	3.750"	5.700"			\$385.00	454/496 BB Chevy	CRK51404966385*	4.250"	6.385"			\$462.00

* Longer than stock stroke. Additional block clearance may be required.

NITRIDED 4340 SERIES

Our NEW Forged 4340 cranks have all the same features of our 5140 cranks but with the added strength of superior 4340 material. These cranks also feature nitrite treating for increased finished hardness and strength. P.A.W. 4340 cranks are an excellent choice for sportsman racing engines and offer a low cost alternative to the more expensive custom crankshafts.

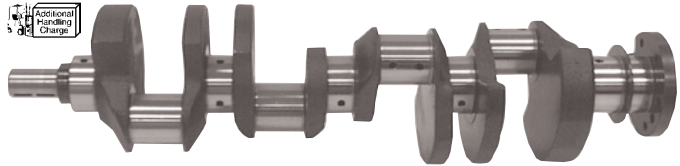

Note: Require M77 "H" bearings or Federal Mogul performance bearings for large crank radius.

These cranks can be ordered with any P.A.W. engine kit. Phone for upgrade prices.

4340 Steel Cranks				Stroke	Rod Length	Price	4340 Steel Cranks				Stroke	Rod Length	Price
CHEVROLET							CHEVROLET Continued						
350 Chevy	CRK43403505700	3.480"	5.700"			\$554.00	454/496 BB Chevy	CRK43404966385*	4.250"	6.385"			\$672.00
350 Chevy '86 & later 1-pc. seal	CRK43403507001	3.480"	5.700"			\$554.00							
350/383 Chevy	CRK43403835700*	3.750"	5.700"			\$554.00							
350/383 SB Chevy '86 & later 1-pc seal	CRK43403835701*	3.750"	5.700"			\$554.00							
400 SB Chevy	CRK43404005700*	3.750"	5.700"			\$554.00							
400/426 SB Chevy	CRK43404266000*	3.875"	6.000"			\$554.00							
396/427 BB Chevy	CRK43404276135	3.766"	6.135"			\$672.00							
454 BB Chevy	CRK43404546135	4.000"	6.135"			\$671.00							
454 BB Chevy 1-pc seal	CRK434045416135	4.000"	6.135"			\$671.00							
							CHRYSLER						
							440 Chrysler	CRK43404403750	3.750"	6.760"			\$695.00
							440/500 Chrysler	CRK43404404150*	4.150"	6.760"			\$695.00
							FORD						
							302 Ford	CRK43403025090	3.000"	5.090"			\$471.00
							302/327 Ford	CRK43403275400*	3.250"	5.400"			\$471.00
							302/342 Ford	CRK43403425400*	3.400"	5.400"			\$471.00
							351W/420 Ford	CRK43404206200*	4.100"	6.200"			\$604.00

* Longer than stock stroke. Additional block clearance may be required.

CONNECTING RODS

STAGE II SPECIAL HIGH PERFORMANCE CONNECTING RODS



Features:

Shot-peened, checked for both straightness and cracks. Resized on large end, balanced and fitted with new ARP high-performance chrome moly rod bolts for maximum strength.

Make/Model

CHEVROLET

229 V6	Set of 6	\$120.00
194, 230, 250 6 Cyl.	Set of 6	\$120.00
283 Small Journal		
11/32" bolts	Set of 8	\$160.00
262/267/305 V8 Large		
Journal 3/8" bolts		\$160.00
307/327/350 Large		
Journal 3/8" bolts		\$160.00
400 SB 3/8" Bolts		\$160.00
427/454 3/8" Bolts		\$160.00

CHRYSLER

318 Bushed Rod 3/8" Bolts		\$240.00
340 Bushed Rod 3/8" Bolts		\$240.00
318/360 3/8" Bolts (pressed pin style)		\$160.00
383 3/8" Bolts		\$160.00

FORD

260 V8		\$160.00
302 V8		\$160.00
351W		\$160.00
351M-400		\$160.00
429-460 ('68-'78)		\$160.00

OLDSMOBILE

260/330/350 (gas engine)		\$160.00
403 3/8" bolts		\$160.00

PHONE FOR AVAILABILITY



CHROME MOLY ROD BOLTS



ARP's High Performance chrome moly connecting rod bolts are premium-grade fasteners designed for use as direct replacements in factory steel rods. These bolts are made from 8740 chrome moly steel and are cold forged into shape to maintain molecular integrity. The large underhead radius adds superior strength. They are ground and thread-rolled after heat treat to insure extremely close tolerance and precise fit. Black oxide finish is applied to provide an aerospace-quality fastener with a 190,000 PSI tensile strength rating.

Description	Part#	Price
CHEVROLET		
283/327	11/32" Dia. (Set of 16)	ARP-134-6001 \$60.95
350	3/8" Dia. (Set of 16)	ARP-134-6003 \$51.95
400	3/8" Dia. (Set of 16)	ARP-134-6002 \$57.95
396/402/427/454	3/8" Dia. (Set of 16)	ARP-135-6002 \$57.95
427/454	7/16" Dia. (Set of 16)	ARP-135-6001 \$59.95
CHRYSLER		
273/318/340/360	3/8" Dia. (Set of 16)	ARP-144-6001 \$57.95
383/426 Wedge	3/8" Dia. (Set of 16)	ARP-145-6002 \$57.95
440	3/8" Dia. (Set of 16)	ARP-145-6002 \$57.95
FORD		
289/302 Std.	5/16" Dia. (Set of 16)	ARP-154-6002 \$57.95
351W	3/8" Dia. (Set of 16)	ARP-150-6004 \$57.95
351C	3/8" Dia. (Set of 16)	ARP-154-6003 \$57.95
351M/400	3/8" Dia. (Set of 16)	ARP-154-6001 \$57.95
352/390/428	3/8" Dia. (Set of 16)	ARP-154-6002 \$57.95
429/460	3/8" Dia. (Set of 16)	ARP-155-6003 \$57.95
OLDSMOBILE		
350/403	3/8" Dia. (Set of 16)	ARP-184-6001 \$57.95
455	3/8" Dia. (Set of 16)	ARP-185-6001 \$57.95
PONTIAC		
350/400/455 ('63 & Up)	3/8" Dia. (Set of 16)	ARP-190-6001 \$57.95

CONNECTING ROD SPECIALS



P.A.W. 5140 ULTRA STOCK SERIES I-BEAM RODS



Our "Ultra Stock" Series I-Beam Rods are forged from 5140 steel for maximum strength. They feature ARP chrome moly rod bolts (3/8" unless noted) and shotpeen finish. These rods are perfect for any hi-performance street, street strip or racing application where stock style rods are required. **Bushed rods must use pistons that have floating wrist pins!**

Part No.	Application	Price/Set of 8
SB CHEVY 283, 327 SJ (2.000" Small Journal)		
PAR-SR5700SJB	SB Chevy 327 SJ 2.00" RJ Diameter Length 5.700" Standard Length Bushed, Pin Dia., .927"	\$250.00
PAR-SR5700SJP	SB Chevy 327 SJ 2.00" RJ Diameter Length 5.700" Standard Length Press, Pin Dia., .927"	\$250.00
SB CHEVY 305, 350 LJ (2.100" Large Journal)		
PAR-SR5700B	SB Chevy 350 LJ Length 5.700" 2.100" RJ Bushed, Pin Dia., .927"	\$240.00
PAR-SR5700P	SB Chevy 350 LJ Length 5.700" 2.100" RJ Press, Pin Dia., .927"	\$240.00
PAR-SR6000B	SB Chevy 350 LJ Length 6.000" Bushed, Pin Dia., .927"	\$250.00
PAR-SR6000P	SB Chevy 350 LJ Length 6.000" Press, Pin Dia., .927"	\$250.00
PAR-SR6200B	SB Chevy 350 LJ Length 6.200" Bushed, Pin Dia., .927"	\$250.00
BB CHEVY 396, 427, 454, 502 (2.200" Rod Journal)		
PAR-SR6135B	BB Chevy 396, 402, 427, 454, 502 Length 6.135" Bushed, Pin Dia., .990" 7/16" Rod Bolts!	\$250.00
PAR-SR6135P	BB Chevy 396, 402, 427, 454, 502 Length 6.135" Press, Pin Dia., .990" 7/16" Rod Bolts!	\$250.00
PAR-SR6385B	BB Chevy 396, 402, 427, 454, 502 Length 6.385" (+ .250") Bushed, Pin Dia., .990" 7/16" Rod Bolts!	\$260.00
SB CHRYSLER 318, 340, 360 (2.125" Rod Journal)		
PAR-SR6123B	SB Chrysler 318, 340, 360 Length 6.123" Standard Length Bushed, Pin Dia., .984"	\$250.00

Part No.	Application	Price/Set of 8
RB CHRYSLER 413, 426W, 440 (2.375" Rod Journal)		
PAR-SR6760P	RB Chrysler 413, 426W, 440 Length 6.760" Standard Length Press, Pin Dia., 1.094" 7/16" Rod Bolts!	\$264.00
FORD 289 (2.125" Rod Journal)		
PAR-SR5155B	Ford 289 Length 5.155" Standard Length Bushed, Pin Dia., .912" 3/8" Rod Bolts!	\$240.00
FORD 302 (2.125" Rod Journal)		
PAR-SR5090B	Ford 302 Length 5.090" Standard Length Bushed, Pin Dia., .912" 3/8" Rod Bolts!	\$240.00
PAR-SR5090P	Ford 302 Length 5.090" Standard Length Press, Pin Dia., .912" 3/8" Rod Bolts!	\$240.00
PAR-SR5400B	Ford 302 Stroker Rod Length 5.400" Bushed, Pin Dia., .912" 3/8" Rod Bolts!	\$250.00
PAR-SR5400B927	Ford 302 Stroker Rod w/Chevy Pin Diameter Length 5.400" Bushed, Pin Dia., .927" 3/8" Rod Bolts!	\$260.00
FORD 351W (2.310" Rod Journal)		
PAR-SR5956B	Ford 351W Length 5.956" Standard Length Bushed, Pin Dia., .912" 3/8" Rod Bolts!	\$240.00
FORD 351W / 420 Stroker Rod (2.100" Rod Journal)		
PAR-SR6200B	Ford 351W / 420 Stroker Rod Length 6.200" Special Stroker Rod Length Bushed, Pin Dia., .927" 2.100" Rod Journal	\$250.00
FORD 429, 460 (2.500" Rod Journal)		
PAR-SR6605P	Ford 429, 460 Length 6.605" Standard Length Press, Pin Dia., 1.040"	\$260.00
PONTIAC 326-455 (2.249" Rod Journal)		
PAR-SR6625P	Pontiac 326-455 Length 6.625" Standard Length Press, Pin Dia., .980"	\$260.00



SUPERSTOCK CONNECTING RODS



The perfect rod for the perfect rebuild. Our P.A.W. Super Stock Connecting Rods are thoroughly cleaned, shotpeened, checked for cracks and straightness and resized to OE specifications. Sold outright — no exchange necessary.

**Available for many different 6 Cylinder
and V8 domestic engines.
PHONE FOR PRICE AND AVAILABILITY**

CONNECTING ROD SPECIALS



4340 H-BEAM STEEL RACING RODS



PAR-HR5700

FROM
\$360⁰⁰
SET of 8

P.A.W. H-beam racing rods are manufactured from aircraft quality 4340 steel. Using modern CAD (Computer Aided Design) programs produces a lightweight racing rod without sacrificing any strength. Rods and caps are separated in the forged process for optimum internal grain flow and structural integrity. These H-beam racing rods are perfect for Chevy small blocks producing 700 hp and Chevy big blocks producing 800 hp. Perfect for drag race, oval track and street applications.

P.A.W. H-beam racing rods incorporate these features:

- Every rod is magnafluxed, X-rayed, and ultrasonic tested to ensure quality.
- Weight control within ± 2 grams in a set.
- Specially designed 7/16" ARP 8740 cap screws.
- Bushed rods must use pistons that have floating wrist pins.
- A third hole drilled at the end of the bushing releases any aerated lubricant.
- Bronze wrist pin bushings are made to withstand high impact forces.
- Sold in sets only.

Part No.	Application	Price/Set of 8
CHEVROLET 305, 350 LJ (2.100" Rod Journal)		
PAR-HR5700	SB Chevy 350 Length 5.700" Standard Length Bushed, Pin Dia., .927"	\$360.00
PAR-HR5700P	SB Chevy 350 Length 5.700" Standard Length Pressed, Pin Dia., .927"	\$360.00
PAR-HR6000	SB Chevy 350 Length 6.000" (+ .300" Length) Bushed, Pin Dia., .927"	\$360.00
CHEVROLET 396-502 H-Beam Connecting Rods (2.200" Rod Journal)		
PAR-HR6135	BB Chevy 396, 402, 427, 454, 502 Length 6.135" Standard Length Bushed, Pin Dia., .990"	\$384.00
PAR-HR6385	BB Chevy 396, 402, 427, 454, 502 Length 6.385" (+ .250") Bushed, Pin Dia., .990"	\$384.00
PAR-HR6535	BB Chevy 396, 402, 427, 454, 502 Length 6.535" (+ .400") Bushed, Pin Dia., .990"	\$384.00
PAR-HR6800	BB Chevy 396, 402, 427, 454, 502 Length 6.800" (+ .665") Bushed, Pin Dia., .990"	\$384.00
CHRYSLER SB 318, 340, 360 (2.125" Rod Journal)		
PAR-HR6123	SB Chrysler 318, 340, 360 Stock Length 6.123" Bushed, Pin Dia., .984"	\$384.00
CHRYSLER RB 413, 426W, 440 (2.375" Rod Journal)		
PAR-HR6760	RB Chrysler 413, 426W, 440 Stock Length 6.766" with ARP 2000 Rod Bolts Bushed, Pin Dia., 1.094"	\$448.00
PAR-HR6760-990	RB Chrysler 413, 426W, 440 Stock Length 6.766" with ARP 2000 Rod Bolts Bushed, Pin Dia., .990" (BBC Chevy Dia.)	\$448.00
FORD 4.6L Modular (2.086" Journal)		
PAR-HR5933	Ford 4.6L Stock Length 5.933" with ARP 2000 Rod Bolts Bushed, .990" Pin Dia.	\$408.00

Part No.	Application	Price/Set of 8
FORD 302, 5.0L (2.123" Rod Journal)		
PAR-HR5090	Ford 302, 5.0L Stock Length 5.090" Bushed, Pin Dia., .912"	\$360.00
FORD 302, 5.0L Stroker Rod (2.123" Rod Journal)		
PAR-HR5315F	Ford 302, 5.0L Special Length 5.315" Bushed, Pin Dia., .912"	\$360.00
FORD 302, 5.0L Stroker Rod (2.123" Rod Journal)		
PAR-HR5400F	Ford 302, 5.0L Special Length 5.400" Bushed, Pin Dia., .912"	\$360.00
FORD 302, 5.0L Stroker Rod (2.123" Rod Journal)		
PAR-HR5400F927	Ford 302, 5.0L Special Length 5.400" Bushed, Pin Dia., .927" Chevy Pin	\$360.00
FORD 351W (2.310" Rod Journal)		
PAR-HR5956	Ford 351W Stock Length 5.956" Bushed, Pin Dia., .912"	\$360.00
FORD 351W / 420 Stroker Rod (2.100" Rod Journal)		
PAR-HR6200	Ford 351W / 420 Stroker Rod Length 6.200" Special Stroker Rod Length Bushed, Pin Dia., .927"	\$360.00
FORD 390, 427, 428 (2.438" Rod Journal)		
PAR-HR6490	Ford 390, 427, 428 Stock Length 6.490" Bushed, Pin Dia., .975"	\$448.00
FORD 429, 460 (2.500" Rod Journal)		
PAR-HR6605	Ford 429, 460 Stock Length 6.605" Bushed, Pin Dia., 1.040"	\$384.00
PONTIAC 326, 350, 389, 400, 421, 428, 455 (2.249" Rod Journal)		
PAR-HR6625	Pontiac 326-455 Stock Length 6.625" Bushed, Pin Dia., .980"	\$384.00
PAR-HR6625P	Pontiac 326-455 Stock Length 6.625" Pressed, Pin Dia., .980"	\$384.00

*Requires pistons that have floating wrist pins which use either lock rings or spiral locks to retain piston pins.

CONNECTING ROD SPECIALS



4340 I-BEAM LIGHTWEIGHT STEEL RACING RODS

P.A.W. I-beam lightweight racing rods are designed for high strength and a significant weight reduction. P.A.W. I-Beam racing rods are manufactured from aircraft quality 4340 steel billet and represent the ultimate state-of-the-art technology and manufacturing excellence. These P.A.W. racing rods are perfect for engines producing 800 hp.



FROM
\$367⁶⁰
SET of 8

PAR-IR5700L

P.A.W. 4340 I Beam Lightweight Racing Rods incorporate these features:

- *Every rod is magnafluxed, X-rayed, and ultrasonic tested to ensure quality.*
- *Specially designed 7/16" ARP 8740 cap screws!*
- *Weight control within ± 2 grams in a set.*
- *Bronze wrist pin bushings are made to withstand high impact forces.*
- *A third hole drilled at the end of the bushing releases any aerated lubricant.*
- *Sold in sets only.*
- *Bushed rods must use pistons that have floating wrist pins.*

Part No.	Application	Price
CHEVY SB 305, 327 LJ, 350 (2.100" Rod Journal)		
PAR-IR5700L	SB Chevy 350 Length 5.700" Standard Length Bushed, Pin Dia., .927"	\$367.60
PAR-IR6000L	SB Chevy 350 Length 6.00" (+.300" Length) Bushed, Pin Dia., .927"	\$367.60
PAR-IR6125L	SB Chevy 350 Length 6.125" (+.425" Length) Bushed, Pin Dia., .927"	\$450.00
PAR-IR6200L	SB Chevy 350 Special Length 6.200" (+.500" Length) Bushed, Pin Dia., .927"	\$367.60
CHEVY 396-502 (2.200" Rod Journal)		
PAR-IR6135L	BB Chevy 396, 402, 427, 454, 502 Length 6.135" Standard Length Bushed, Pin Dia., .990"	\$408.00
PAR-IR6385L	BB Chevy 396, 402, 427, 454, 502 Length 6.385" (+.250") Bushed, Pin Dia., .990"	\$408.00
PAR-IR6535L	BB Chevy 396, 402, 427, 454, 502 Length 6.535" (+.400") Bushed, Pin Dia., .990"	\$408.00

Part No.	Application	Price
FORD 302, 5.0L Stroker Rod (2.123" Rod Journal)		
PAR-IR5400L	Ford 302, 5.0L Special Length 5.400" Bushed, Pin Dia., .912"	\$367.60
FORD 351W (2.310" Rod Journal Diameter)		
PAR-IR5956L	Ford 351W Stock Length 5.956" Bushed, Pin Dia., .912"	\$367.60
FORD 351W / 420 Stroker Rod (2.100" Rod Journal)		
PAR-IR6200L	Ford 351W / 420 Stroker Rod Length 6.200" Special Stroker Rod Length, Special pin dia. Chevy Pin Bushed, Pin Dia., .927"	\$367.60
FORD 390, 427, 428 (2.438" Rod Journal)		
PAR-IR6490L	Ford 390, 427, 428 Stock Length 6.490" Bushed, Pin Dia., .975"	\$472.00
FORD 429, 460 (2.500" Rod Journal)		
PAR-IR6605L	Ford 429, 460 Stock Length 6.605" Bushed, Pin Dia., 1.040"	\$408.00
PONTIAC 326, 350, 389, 400, 421, 428, 455 (2.249" Rod Journal)		
PAR-IR6625B	Pontiac 326-455 Stock Length 6.625" Bushed, Pin Dia., .980"	\$408.00